

PharmaJet®



Injector-0.1mL



Syringe-0.1mL
Needle-free



Filling Adapter

Helpful Tips

Important:

Before you use your PharmaJet Tropis Needle-free Injection device, please read the Instructions For Use and these Helpful Tips completely. Follow the directions carefully when using the Tropis device.

 Refer to Instructions for Use to ensure safe injections and to review risks.

Verify if the Injector is in the charged or uncharged state by confirming the position of the Injector Hammer.

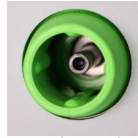

Uncharged



Charged

DO NOT open the Handles when the Injector is charged. If the Injector is charged and the Handles are open, DO NOT touch internal components; close the Handles.

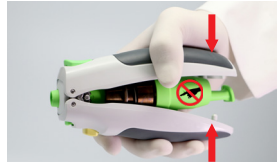

Give the injection at a 90-degree angle, using minimal pressure to retract the green inner core housing and enable activation.

Recommended injection sites include the rear deltoid (suprascapular) for children and adults and lateral thigh for infants.

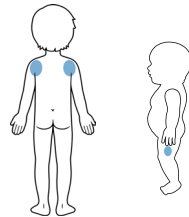

After an injection, eject the Syringe and keep the Injector closed for storage.

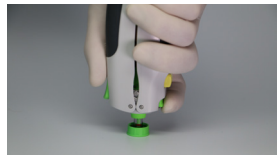

Store the Injector in the uncharged state in the protective case.



Cleaning, Disinfecting, Storage, and Disposal

INSPECTION: Visually inspect the exposed surfaces of the opened Injector for foreign contaminants and soil. If foreign contaminants or soil are present, proceed to cleaning and disinfection. Do not disassemble the device for inspection or for cleaning and disinfection.

CLEANING: Rinse the Injector with potable tap water for at least 2 minutes, rubbing and wiping large debris off device. Wipe device with 70% Isopropyl Alcohol to remove visible soil. Dry the Injector with a clean, absorbent cloth. Visually inspect Injector after cleaning. If debris remains, repeat procedure.

DISINFECTING: Spray the Injector with 70% Isopropyl Alcohol and wipe exposed surfaces for at least 1 minute. Maintain surface wetness with 70% Isopropyl Alcohol during disinfecting process.

STORAGE: Store the Injector in the uncharged and closed configuration, in the protective case.

DISPOSAL: Dispose of used devices in accordance with local requirements.

Storage and Transport Temperature:

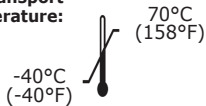

Operating Temperature:

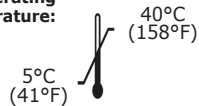

Reorder Information

Item	Catalog #
Injector	C503-10
Syringes – 100 Single Units	C503-34
Syringes – 100 Bulk Units	C503-35
Syringes – 200 Bulk Units	C503-36
Filling Adapters – 100 Single Units	C503-42

Component Description

Injector

1. Activation Button
2. Inner Core Housing
3. Hammer
4. Eject Button
5. Safety Button
6. Handles
7. Latch Button

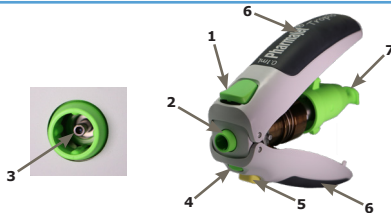

Syringe

1. Syringe Cap
2. Syringe Barrel
3. Syringe Plunger
4. Fill Line

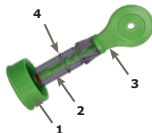

Filling Adapter

1. Syringe Interface
2. Filling Adapter Spike

